

2521 .098" (2.5mm) PITCH CRIMP TERMINAL

Features:

unit:mm

- * THICKNESS: 0.2mm
- * MAT'L: BRASS TIN PLATED
- * USE WITH 1.6mm OR 1.2mm THICKNESS P.C.B
- * MATES WITH: 2520 SERIES HOUSING
- * TERMINAL SOLDER DIRECTLY TO P.C BOARD

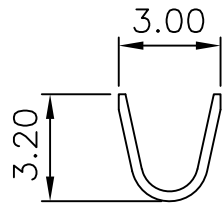

Section A-A'

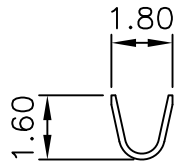

Section B-B'

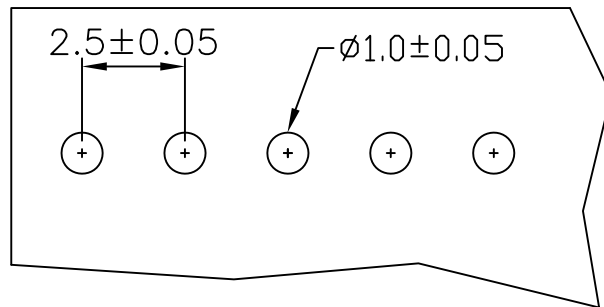

P.C.BOARD LAYOUT

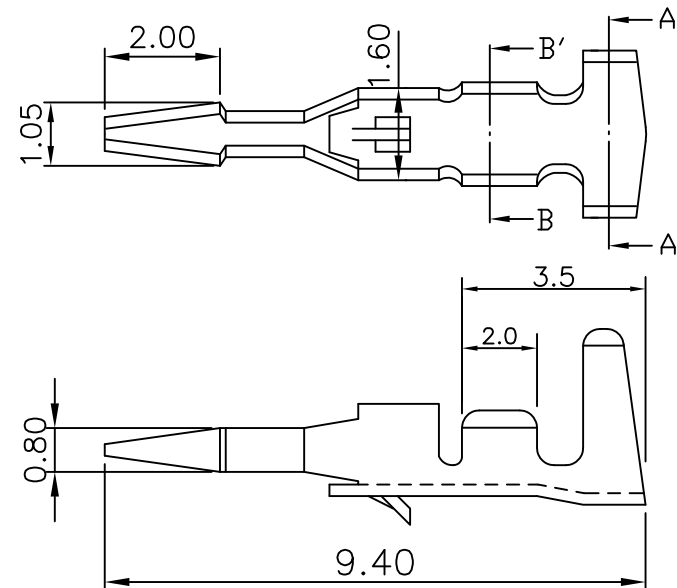

PART NO.	WIRE RANGE	INSULATION O.D.	MATERIAL	FINISH	QTY/REEL
2521	AWG#22-#28	Ø1.9mm MAX	BRASS	Tin-plated	10,000